

Zoning Exhibit For Kenneth Jones

Located in Land Lots 734, 747, & 748
19th District, 2nd Section
City of Powder Springs,
Cobb County, Georgia

Plat Date: April 7, 2026 Scale: 1" = 50'

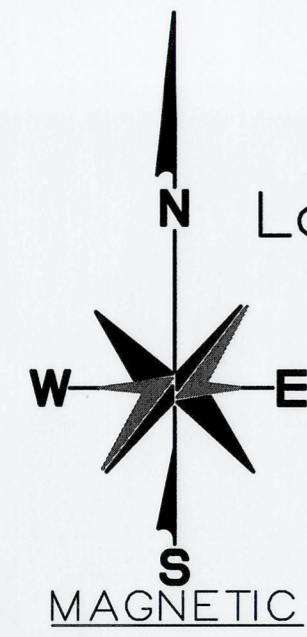

RECORDING INFORMATION

SURVEY NOTES

- Total Area: 10.445 Acres
- This map or plat has been calculated for closure and is found to be accurate within 1 foot in infinite feet. This exhibit is based off record information and no field work has been done by this firm to date.
- This property does lie within a 100 year flood hazard zone as defined by the F.E.M.A. Insurance. This property lies in Zone "AE" (mild risk) and Zone "X" (low risk) per FEMA FIRM Panel 13067C017G (effective 12/16/2008)
- IPF signifies iron pin (1/2 inch re-bar) found unless otherwise noted. IPS signifies 1/2" re-bar set.
- Reference: Warranty Deed between Roy L. Dickson (Grantor) and Paul D. Harris, Kenneth C. Jones and Billy E. Honea (Grantee) dated April 28, 1999 and recorded in Deed Book 12596, Pages 24-25 of Cobb County, Georgia.

N/F
KENT P AMBURN
AND
KIMBERLY O AMBURN
TAX ID:
19073400060

N/F
CITY OF POWDER
SPRINGS
TAX ID:
19074800010

TOTAL AREA=
10.445 ACRES
TAX ID:
19074700080

N/F
CITY OF POWDER
SPRINGS
TAX ID:
19074800010

L.L. 734
L.L. 747

APPROXIMATE
LAND LOT LINE

FEMA FLOOD
ZONE "A"

N52°38'11"E 650.00'

APPROXIMATE
LAND LOT LINE

L.L. 734
L.L. 747

L.L. 733
L.L. 748

APPROXIMATE
LAND LOT LINE

L.L. 733
L.L. 748

822.85' ALONG R/W TO
INTERSECTION OF THE WEST LINE
OF LAND LOT 734 AND THE LINE
NORTH-EAST RIGHT-OF-WAY OF
POWDER SPRINGS DALLAS ROAD
(RECORDED TIE)

POWDER SPRINGS DALLAS ROAD (R/W VARIES)

EXIST. ROAD R/W

P.O.B.

N57°21'49"W 700.00'

POWDER SPRINGS DALLAS ROAD (R/W VARIES)

EXIST. ROAD R/W

FEMA FLOOD
ZONE "A"
FEMA FLOOD
ZONE "X"

S52°38'11"W 850.00'

FEMA REGULATORY
FLOODWAY
FEMA FLOOD
ZONE "A"

S57°21'49"E 700.00'

APPROXIMATE
LAND LOT LINE

FEMA REGULATORY
FLOODWAY
FEMA FLOOD
ZONE "A"

L.L. 747 L.L. 748

GRAPHIC SCALE

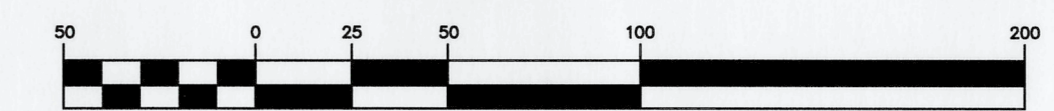

(IN FEET)
1 inch = 50 ft.

25106surv.dwg

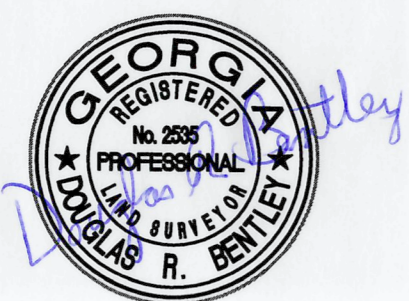

NO.	DATE	DESCRIPTION	BY

PREPARED BY:



ENGINEERING | SURVEYING | CONSTRUCTION MANAGEMENT
300 WI Parkway, Suite 100
Dallas, Georgia 30132
(678) 324-8291