

Building Sketch (Page - 1)

Borrower	Latoya Skinner				
Property Address	5780 Warren Farm Rd SW				
City	Powder Springs	County	Cobb	State	GA Zip Code 30127
Lender/Client	Premier Mortgage Services, LLC				

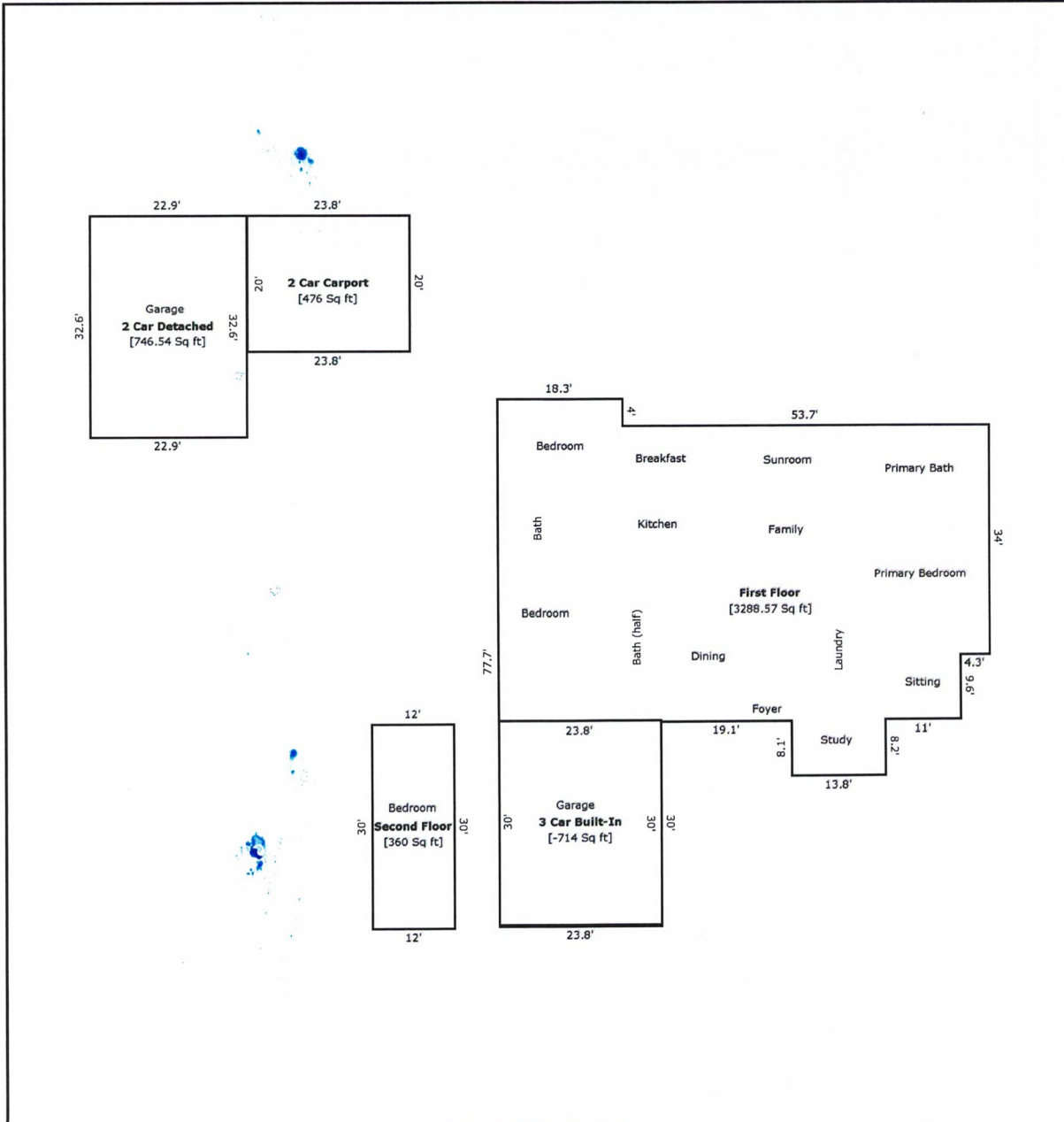

TOTAL Sketch by a la mode

Area Calculations Summary

Living Area		Calculation Details
First Floor	4002.57 Sq ft	$23.8 \times 30 = 714$ $13.8 \times 8.1 = 111.78$ $47.7 \times 18.3 = 872.91$ $43.7 \times 38.4 = 1678.08$ $11 \times 9.6 = 105.6$ $15.3 \times 34 = 520.2$
3 Car Built-In	-714 Sq ft	$30 \times 23.8 = 714$
Second Floor	360 Sq ft	$30 \times 12 = 360$
Total Living Area (Rounded):	3649 Sq ft	
Non-living Area		
2 Car Detached	746.54 Sq ft	$22.9 \times 32.6 = 746.54$
2 Car Carport	476 Sq ft	$23.8 \times 20 = 476$

Building Sketch (Page - 2)

Borrower	Latoya Skinner				
Property Address	5780 Warren Farm Rd SW				
City	Powder Springs	County	Cobb	State	GA Zip Code 30127
Lender/Client	Premier Mortgage Services, LLC				

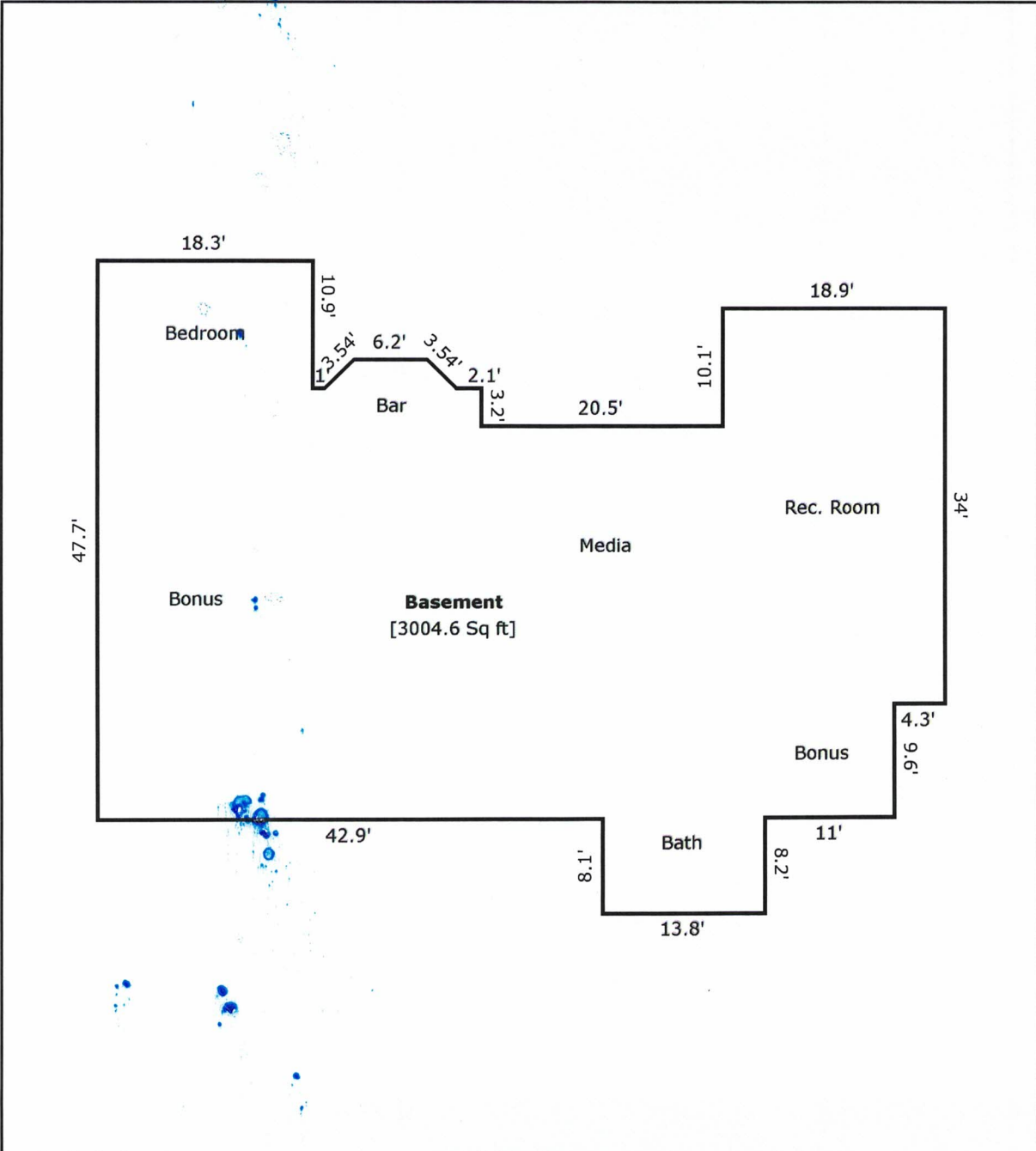

TOTAL Sketch by a la mode

Area Calculations Summary		
Non-living Area		
Basement	3004.6 Sq ft	
		0.5 × 2.5 × 2.5 = 3.12
		0.5 × 2.5 × 2.5 = 3.12
		6.2 × 2.5 = 15.5
		18.3 × 10.9 = 199.47
		36.8 × 32.6 = 1199.68
		13.8 × 8.1 = 111.78
		33.6 × 20.5 = 688.8
		18.9 × 34 = 642.6
		9.6 × 11 = 105.6
		9.7 × 3.6 = 34.92

Aerial Map

Borrower	Latoya Skinner				
Property Address	5780 Warren Farm Rd SW				
City	Powder Springs	County	Cobb	State	GA Zip Code 30127
Lender/Client	Premier Mortgage Services, LLC				



Room Type	Area
A Main Area	2819
B FRAME HALF STORM/MASONRY GARAGE	864
C CONCRETE PATIO	716
D ENCLOSED PORCH/CONCRETE PATIO	285
E OPEN PORCH	152
F CONCRETE PATIO	100
G OPEN PORCH	100

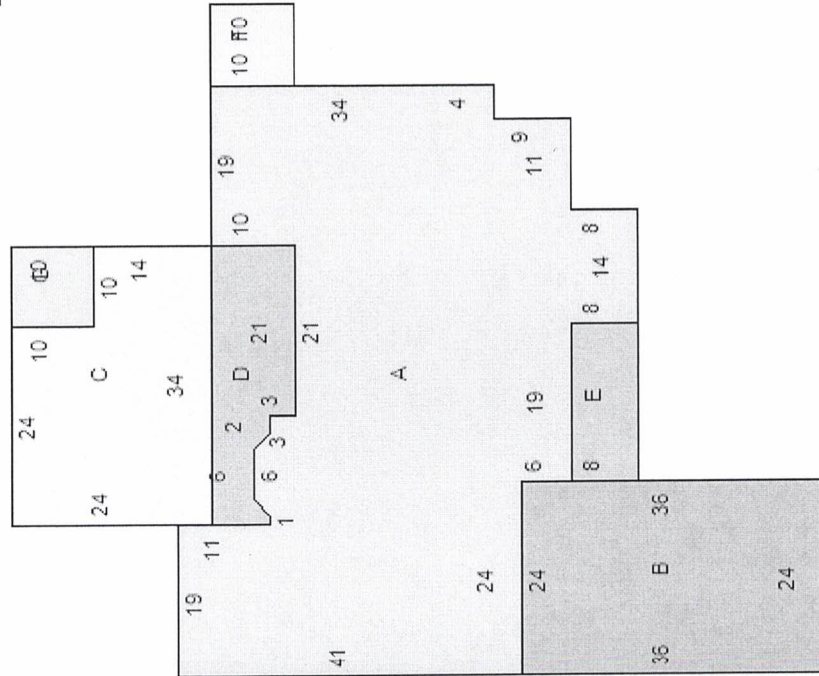

Room Type	Area
A Main Area	2819
B FRAME HALF STORM/MASONRY GARAGE	864
C CONCRETE PATIO	716
D ENCLOSED PORCH/CONCRETE PATIO	285
E OPEN PORCH	152
F CONCRETE PATIO	100
G OPEN PORCH	100

