

MAGNETIC NORTH

Site Address-
5780 C H James Parkway
Suite 110
Powder Springs Commons
Powder Springs, Georgia
30127

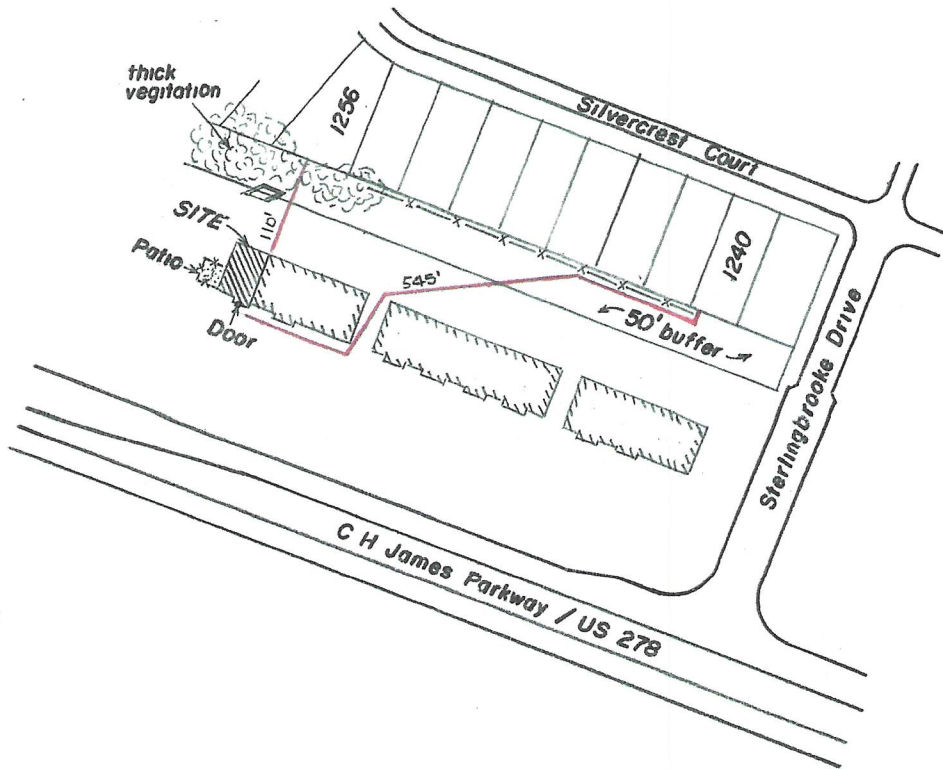

The following distances were measured from the front door of the site by the most direct route of travel on the ground to property line, except as noted:

- CHURCH- 1836' to Grace Baptist Church, @ 5790 Powder Springs-Dallas Road.
- SCHOOL- 1836' to Grace Christian Academy, @ 5790 Powder Springs-Dallas Road.
- RESIDENCE- 545' to 1240 Silvercrest Court.
110' to 1256 Silvercrest Court. (Measured in a straight line from nearest point on site)

The church/school are well in excess of 100' by straight line measurement.

City of Powder Springs Wine, Malt Beverage and Distilled Spirits Consumption on the Premises License Survey for:

1738 Restaurant and Bar LLC



| | | |
|---|------------------|--|
| DATE: 6/13/2023 | SCALE: 1" = 200' | 0 100 200 400 GRAPHIC SCALE IN FEET |
| DRAWN BY: GD | LAND LOT 671 | 19th DISTRICT 2nd SECTION |
| | COBB COUNTY | GEORGIA |
| GEORGIA LAND SURVEYING CO. 155 CLIFTWOOD DRIVE, ATLANTA, GA 30328 PHONE [REDACTED] FAX [REDACTED] WWW.GEORGIALANDSURVEYING.COM | | 204455 |