

**GENERAL SITE NOTES:**

1. TOTAL SITE AREA = ~6.2 AC.
2. DENSITY = 39 UNITS/6.2 AC. = 6.3 UNITS/AC.
3. TOTAL RECREATION AREA REQ. = 1 AC/50 UNITS = 33,977 SF
4. TOTAL RECREATION AREA PROVIDED = 53,624 SF
5. PROP. ZONING = RUD-R
6. BUILDING SETBACKS:  
FRONT: 16'  
REAR: 20' (35' EXTERIOR SETBACK REQ.)  
SIDE: 10'
7. TYPICAL TOWNHOME SHOWN = 24'x50' (W/24'x8' PATIO)
8. MINIMUM DRIVEWAYS TO BE 22' LONG (FROM SIDEWALK)
9. PARKING REQ. = 0.5 SPACES/UNIT = 20 SPACES
10. PARKING PROVIDED = 20 SPACES

NEW MACLAND RD.

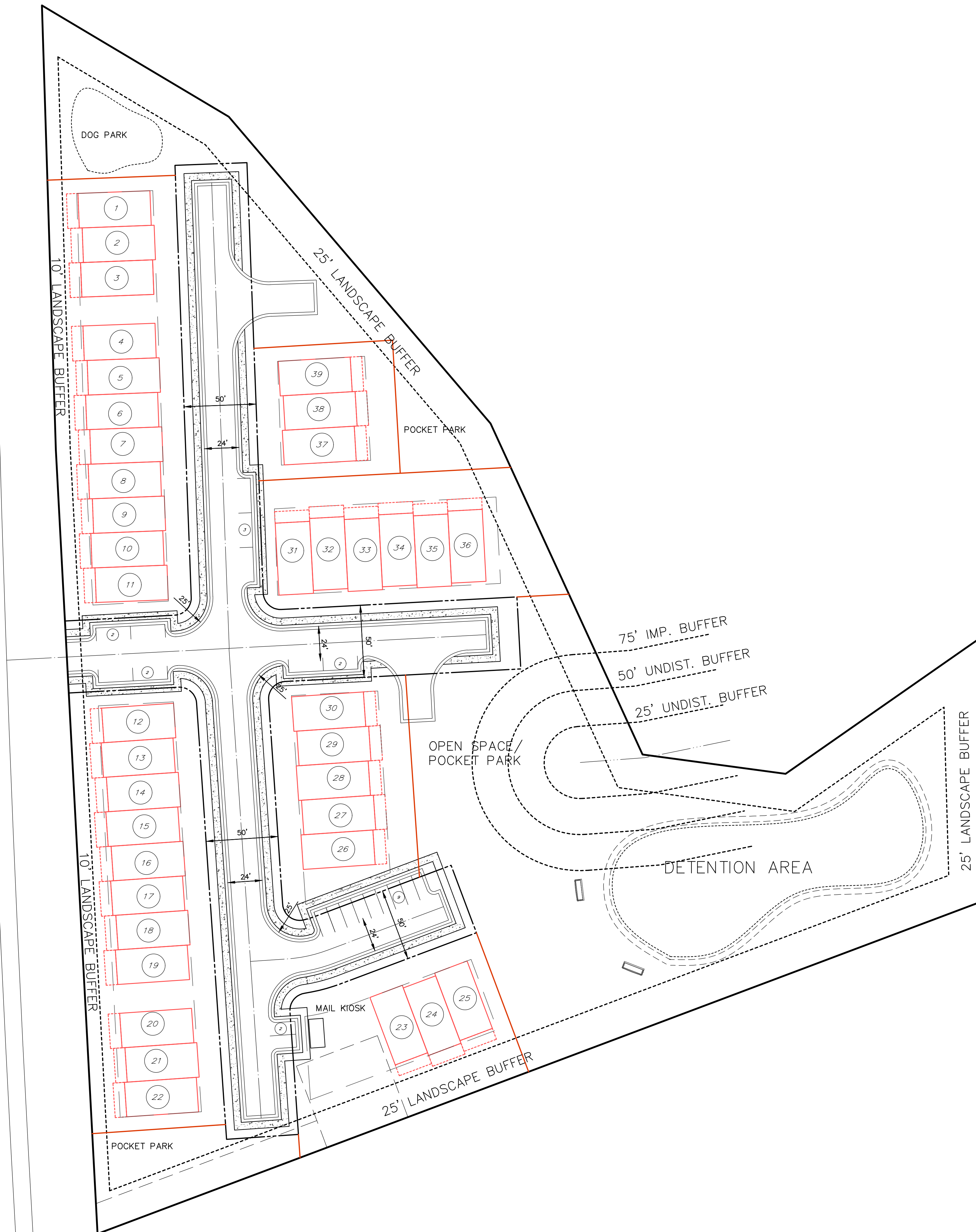

**NEW MACLAND RD TRACT**

CITY OF POWDER SPRINGS  
COBB COUNTY, GA

REVISION DESCRIPTION:

REV.	DESCRIPTION
01	REV. LAYOUT

DRAWN BY:	DH
CHECKED BY:	DH
DATE:	08/12/22
SHEET TITLE: CONCEPTUAL LAYOUT	
SCALE: 1" = 40'	
SHT. NO.	01
REV. NO.	01