

# Erosion Control Notes:

1. EROSION CONTROL PRACTICES MUST COMPLY WITH THE MINIMUM BMP'S FOR JANUARY 2013 NRCS, AND SHALL COMPLY WITH THE STANDARDS/SPECIFICATIONS IN "THE MANUAL FOR EROSION AND SEDIMENT CONTROL IN GEORGIA"
2. IN CONCENTRATED FLOW AREAS, ALL SLOPES STEEPER THAN 2.5:1 AND WITH A HEIGHT TEN FEET OR GREATER, AND CUTS AND FILLS WITHIN STREAM BUFFERS, SHALL BE STABILIZED WITH THE APPROPRIATE EROSION CONTROL MATTING OR BLANKET.
3. MULCH TEMPORARY VEGETATION ON ALL EXPOSED AREAS WITHIN 14 DAYS AFTER DISTURBANCE.
4. WHEN PLANTING VEGETATION, MULCH (HAY OR STRAW) SHOULD BE UNIFORMLY SPREAD OVER SEEDING AREA WITHIN 24 HOURS OF SEEDING.
5. SEDIMENT/EROSION CONTROL DEVICES MUST BE CHECKED AFTER EACH STORM EVENT. EACH DEVICE IS TO BE MAINTAINED OR REPLACED IF SEDIMENT ACCUMULATION HAS REACHED ONE THIRD THE CAPACITY OF THE DEVICE. ADDITIONAL DEVICES MUST BE INSTALLED IF NEW CHANNELS HAVE DEVELOPED.
6. ADDITIONAL EROSION CONTROL DEVICES TO BE USED AS REQUIRED BY CITY OF POWDER SPRINGS INSPECTORS.
7. LIMITS OF CONSTRUCTION DISTURBANCE – THE LIMITS ARE SHOWN ON THIS PLAN AND INCLUDE THE AREA FOR THE PROPOSED BUILDING ADDITION, THE NEW PAVEMENT FOR DRAINAGE, AND THE FIRE TRUCK ACCESS DRIVEWAY.
8. CRITICAL SLOPE: SPECIAL CARE MUST BE TAKEN TO STABILIZE THIS SLOPE WITH SOD OR PLANTS/MULCH AS WELL AS SURFACE ROUGHENING DURING CONSTRUCTION. THERE ARE NO CRITICAL SLOPES ON THIS LOT.
9. NO LAND DISTURBANCE IS TO TAKE PLACE ON ANY ADJACENT LOT THAT IS NOT PROPERTY OF THE OWNER.
10. CONTRACTOR TO VERIFY ALL ELEVATIONS BEFORE ANY CONSTRUCTION.
11. ALL GRASSING SHALL BE IN ACCORDANCE WITH CHAPTER 6, SECTION III "VEGETATIVE PRACTICES" OF THE MANUAL FOR EROSION AND SEDIMENT CONTROL IN GEORGIA.
12. THE CONTRACTOR SHALL CLEAN OUT ALL ACCUMULATED SILT FROM THE DETENTION AND SEDIMENT PONDS ONCE ALL DISTURBED AREAS ARE STABILIZED WITH PERMANENT VEGETATION.
13. EROSION CONTROL DEVICES WILL BE IN PLACE BEFORE SITE DISTURBANCE AND WILL BE PERIODICALLY INSPECTED AND REPAIRED OR RESTORED AS NEEDED TO FUNCTION PROPERLY UNTIL PERMANENT MEASURES ARE ESTABLISHED AND PROJECT IS COMPLETE, I.E.: CONSTRUCTION EXITS AND SILT FENCES SHALL BE RE-TOPPED OR CLEANED AS SILT REDUCES THEIR EFFECTIVENESS.
14. ANY ADDITIONAL CONSTRUCTION OTHER THAN SHOWN ON THIS PLAN WILL REQUIRE SEPARATE AND ADDITIONAL EROSION AND SEDIMENT CONTROL MEASURES AND APPROVAL. ALL DISTURBED AREAS WILL BE PERMANENTLY LANDSCAPED AND GRASSED AS SOON AS CONSTRUCTION PHASES PERMIT
15. ALL WORK SHALL BE PERFORMED IN ACCORDANCE WITH THE SPECIFICATION OF THE MANUAL FOR EROSION AND SEDIMENT CONTROL IN GEORGIA.
16. ADDITIONAL MEASURES MAY BE REQUIRED TO CONTROL EROSION AS DETERMINED NECESSARY BY INSPECTORS. THE EROSION CONTROL MEASURE CAN BE DESIGNED BY A LEVEL 1A (BLUE CARD) GASWCC CERTIFIED CONTRACTOR, UNLESS THE BMP HAS A HYDRAULIC COMPONENT. FOR ALL BMP DESIGN WITH A HYDRAULIC COMPONENT, THE BMP MUST BE DESIGNED BY A LEVEL 2 (GOLD CARD) GASWCC CERTIFIED DESIGNER. A CONSTRUCTION EXIT IS NOT PROPOSED DUE TO THE SMALL SIZE OF THE PROJECT AND THE LEVEL 1A CONTRACTOR MUST PROVIDE ALL MEASURES TO PREVENT ANY SILT FROM ENTERING THE ROADWAY. THIS INCLUDES CLEANING ANY MACHINES ON THE PROPERTY BEFORE TRANSPORTING THEM AWAY. IF THE CONTRACTOR CANNOT KEEP SILT FROM LEAVING THE SITE AT THE ENTRANCE, THEN A CONSTRUCTION EXIT WILL BE REQUIRED.
17. Ds1 / Ds2 / Ds3 IS TO BE APPLIED TO ALL DISTURBED AREAS.
18. NO WASTE WILL BE DISPOSED OF INTO STORM WATER SYSTEM INLETS OR WATERS OF THE STATE EXCEPT AS AUTHORIZED BY A SECTION 404 PERMIT.
19. ALL WASTE MATERIALS WILL BE COLLECTED AND STORED IN A SECURELY LIDDED METAL DUMPSTER. THE DUMPSTER WILL MEET ALL SOLID WASTE MANAGEMENT REGULATIONS. ALL TRASH AND CONSTRUCTION DEBRIS FROM THE SITE WILL BE DEPOSITED IN THE DUMPSTER. THE DUMPSTER WILL BE EMPTIED A MINIMUM OF ONCE PER WEEK OR MORE OFTEN IF NECESSARY AND TRASH WILL BE HAULED AS REQUIRED BY LOCAL REGULATIONS. NO CONSTRUCTION WASTE WILL BE BURIED ONSITE.
20. ALL PERSONNEL WILL BE INSTRUCTED ON PROPER PROCEDURES FOR WASTE DISPOSAL. A NOTICE STATING THESE PRACTICES WILL BE POSTED AT THE JOBSITE AND THE CONTRACTOR WILL BE RESPONSIBLE FOR SEEING THAT THESE PROCEDURES ARE FOLLOWED.
21. BEST MANAGEMENT PRACTICES AS SET FORTH IN SUBSECTIONS (C)(2) AND (3) OF THE CITY OF POWDER SPRINGS UDC SHALL BE REQUIRED FOR ALL LAND-DISTURBING ACTIVITIES. PROPER DESIGN, INSTALLATION, AND MAINTENANCE OF BEST MANAGEMENT PRACTICES SHALL CONSTITUTE A COMPLETE DEFENSE TO ANY ACTION BY THE DIRECTOR OR TO ANY OTHER ALLEGATION OF NONCOMPLIANCE WITH PARAGRAPH (2)B. OF THE CITY OF POWDER SPRINGS UDC SUBSECTION OR ANY SUBSTANTIALLY SIMILAR TERMS CONTAINED IN A PERMIT FOR THE DISCHARGE OF STORM WATER ISSUED PURSUANT TO SUBSECTION (F) OF O.C.G.A. 12-5-30, THE "GEORGIA WATER QUALITY CONTROL ACT".
22. THERE ARE WATERS OF THE STATE OF GEORGIA WITHIN 200 FEET OF THE SITE. THE RECEIVING WATERS ARE POWDER SPRINGS CREEK. ALL APPROPRIATE STATE WATER BUFFERS ARE SHOWN ON THE SITE PLANS. THERE ARE NO PROPOSED IMPACTS TO ANY STATE WATERS PER THESE CONSTRUCTION DOCUMENTS.
23. AN AREA IDENTIFIED AS "DISPOSAL AREA" SHOWN AS A BMP FOR CONCRETE WASH-DOWN OF TOOLS, CONCRETE MIXER CHUTES, HOPPERS AND THE REAR OF VEHICLES. AS NECESSARY TO BE INSTALLED TO PREVENT SILT FORM LEAVING THE SITE (SAME AS Co). WASHOUT OF THE DRUM AT THE CONSTRUCTION SITE IS PROHIBITED.
24. NON-EXEMPT ACTIVITIES SHALL NOT BE CONDUCTED WITHIN THE 25 OR 50-FOOT UNDISTURBED STREAM BUFFERS AS MEASURED FROM THE POINT OF WRESTED VEGETATION WITHOUT FIRST ACQUIRING THE NECESSARY VARIANCES AND PERMITS.
25. ANY AMENDMENT TO EROSION CONTROL PLANS WHICH HAVE A SIGNIFICANT EFFECT ON BMP'S WITH A HYDRAULIC COMPONENT MUST BE CERTIFIED BY THE DESIGN PROFESSIONAL.

THE ESCAPE OF SEDIMENT FROM THE SITE SHALL BE PREVENTED BY THE INSTALLATION OF EROSION AND SEDIMENT CONTROL MEASURES AND PRACTICES PRIOR TO, OR CONCURRENT WITH, LAND-DISTURBING ACTIVITIES.

EROSION CONTROL MEASURES WILL BE MAINTAINED AT ALL TIMES. IF FULL IMPLEMENTATION OF THE APPROVED PLAN DOES NOT PROVIDE FOR EFFECTIVE EROSION CONTROL, ADDITIONAL EROSION AND SEDIMENT CONTROL MEASURES SHALL BE PROVIDED BY THE CONTRACTOR FOR EFFECTIVE EROSION IMPLEMENTED TO CONTROL OR TREAT THE SEDIMENT SOURCE.

ANY DISTURBED AREA LEFT EXPOSED FOR A PERIOD GREATER THAN 14 DAYS SHALL BE STABILIZED WITH MULCH OR TEMPORARY SEEDING. EROSION CONTROL AND TREE PROTECTION MEASURES SHALL BE INSTALLED PRIOR TO ANY OTHER CONSTRUCTION ACTIVITY AND MAINTAINED UNTIL PERMANENT GROUND COVER IS ESTABLISHED.

**24 HOUR EMERGENCY CONTACT: TIM MCTYRE (404) 317-6489**

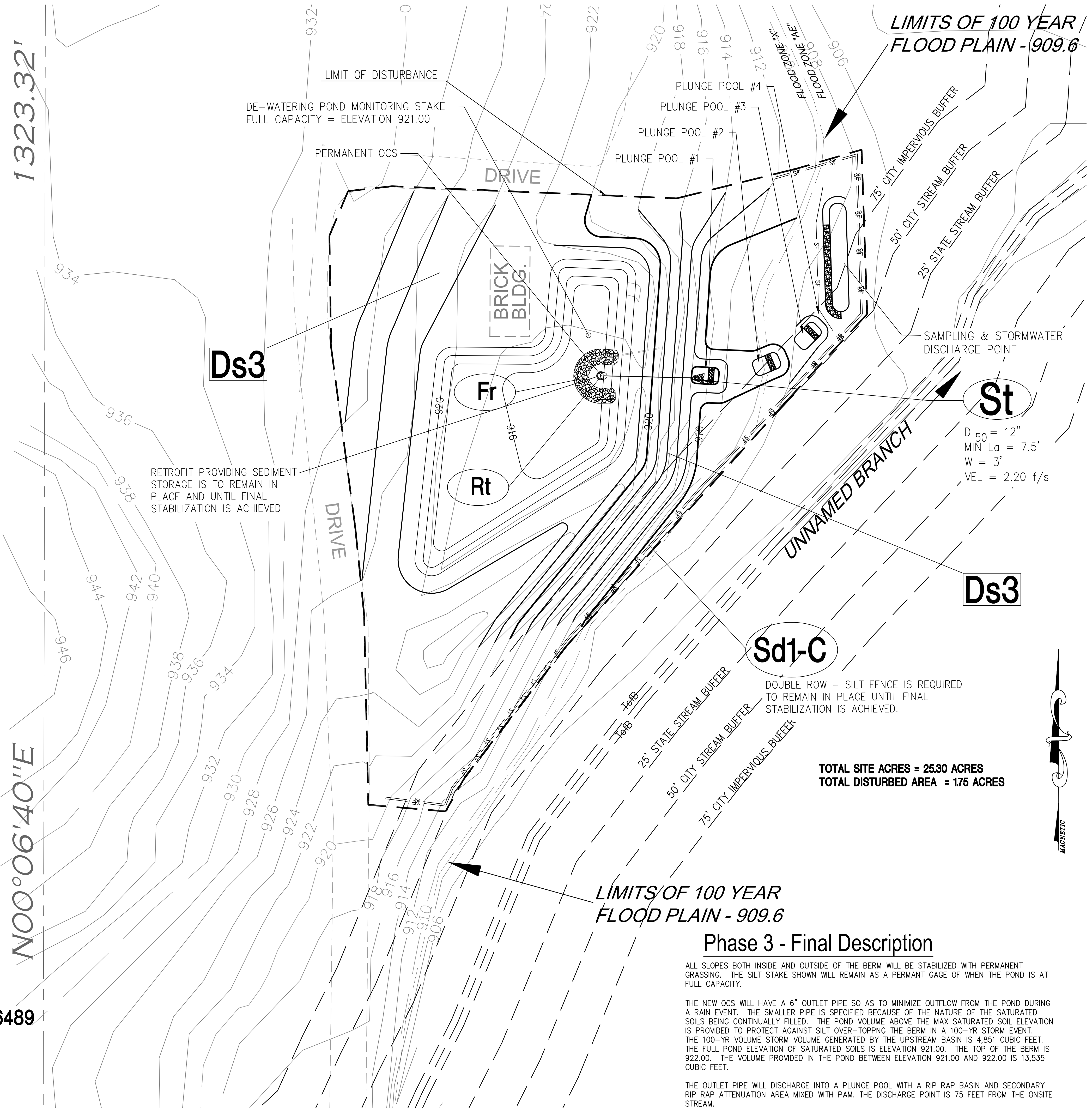
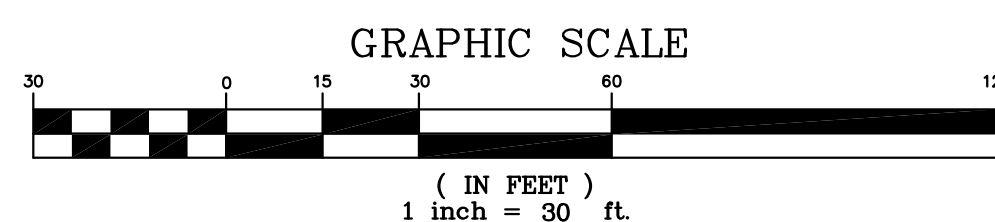

TOTAL SITE ACRES = 2530 ACRES  
TOTAL DISTURBED AREA = 175 ACRES

LIMITS OF 100 YEAR FLOOD PLAIN - 909.6  
**Phase 3 - Final Description**

ALL SLOPES BOTH INSIDE AND OUTSIDE OF THE BERM WILL BE STABILIZED WITH PERMANENT GRASSING. THE SILT STAKE SHOWN WILL REMAIN AS A PERMANT GAGE OF WHEN THE POND IS AT FULL CAPACITY.

THE NEW OCS WILL HAVE A 6" OUTLET PIPE SO AS TO MINIMIZE OUTFLOW FROM THE POND DURING A RAIN EVENT. THE SMALLER PIPE IS SPECIFIED BECAUSE OF THE NATURE OF THE SATURATED SOILS BEING CONTINUALLY FILLED. THE POND VOLUME ABOVE THE MAX SATURATED SOIL ELEVATION IS PROVIDED TO PROTECT AGAINST SILT OVER-TOPPING THE BERM IN A 100-YR STORM EVENT. THE 100-YR VOLUME STORM VOLUME GENERATED BY THE UPSTREAM BASIN IS 4,851 CUBIC FEET. THE FULL POND ELEVATION OF SATURATED SOILS IS ELEVATION 921.00. THE TOP OF THE BERM IS 922.00. THE VOLUME PROVIDED IN THE POND BETWEEN ELEVATION 921.00 AND 922.00 IS 13,535 CUBIC FEET.

THE OUTLET PIPE WILL DISCHARGE INTO A PLUNGE POOL WITH A RIP RAP BASIN AND SECONDARY RIP RAP ATTENUATION AREA MIXED WITH PAM. THE DISCHARGE POINT IS 75 FEET FROM THE ONSITE STREAM.

Prepared By:  
**CRESCENT VIEW ENGINEERING, LLC.**  
211 Frazer Street  
Mableton, GA 30080  
678-324-8410  
www.crescentvieweng.com

Prepared For  
**Tim McTyre**  
4818 Hill Road  
Powder Springs, GA 30127  
(404) 317-6489

ES&PC Plan for SUP

DATE	SCALE	AS SHOWN	10-9-19	REVISIONS	FINAL ES/PC FOR SUP
10-6-17	AS SHOWN	10-9-19			
DRAWN	PZ				
CHECKED	GHB				

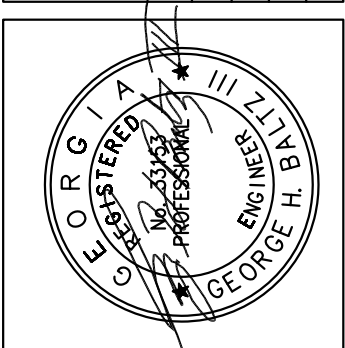

ES&PC Plans For  
**4818 Hill Road**  
Land Lot 899 19th District  
City of Powder Springs, Cobb County, Georgia

CVE PI# 17-347

Sheet No.  
**C-1.4**